

PZ24-12000027

07/02/2025

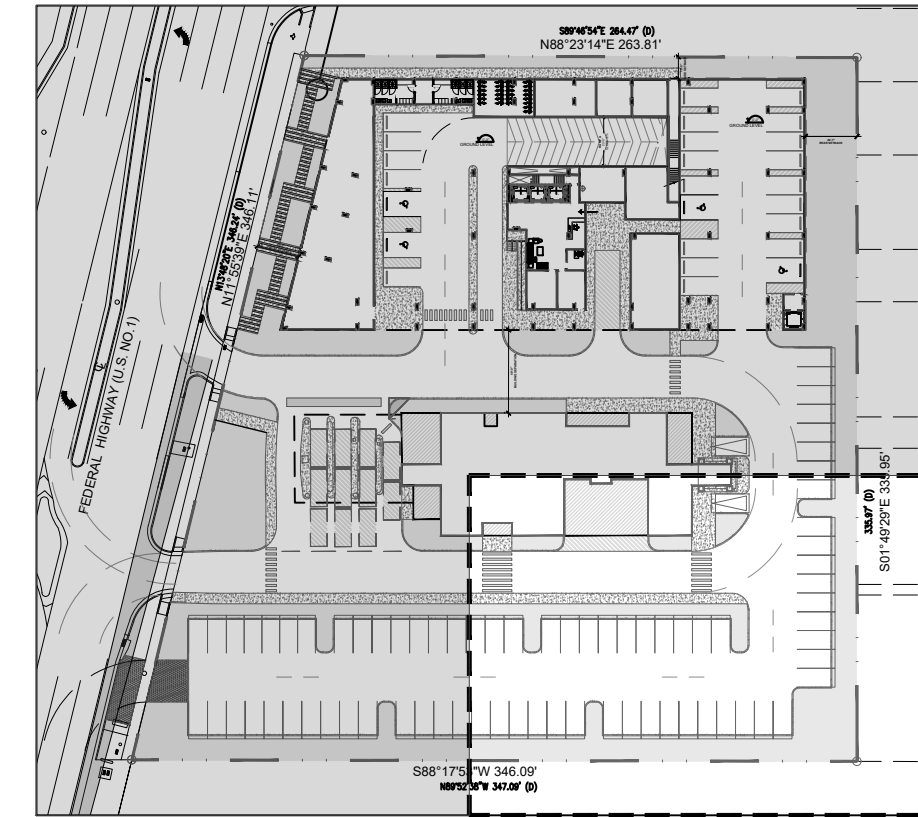

**absolute-idea.com**

**CANAL PARK**  
3323 NE 163rd Street, Suite 200 North Miami Beach, FL 33160  
(t) 305.792.0015 (f) 305.931.0279 @info@absolute-idea.com

REAL

KEN GARDNER  
FL LA 1589

TO THE BEST OF MY KNOWLEDGE, THE PLANS AND SPECIFICATIONS COMPLY WITH THE APPLICABLE MINIMUM BUILDING CODES AND THE APPLICABLE PRESCRIPTIVE REQUIREMENTS AS DETERMINED BY THE LOCAL AUTHORITY IN ACCORDANCE WITH THIS SECTION AND ALL RELATED SECTIONS.

Professionals

idea  
Architect

30 YEARS FLYNN ENGINEERING

GSA DESIGN

[illegible]

ALL MEASUREMENTS MUST BE VERIFIED BEFORE  
BEGINNING THE WORKS. NO MEASUREMENTS ARE TO  
BE SCALED DIRECTLY FROM THIS DRAWING.

Key section

**PROGRESS  
SET**

Client

**VERA FUND**  
NICK POLYUSHKIN  
& YURI KHARITONENKOV  
TEL: 305.833.3303

Project

**1600 S FEDERAL HIGHWAY  
(MIXED-USE PROJECT)**

**1600 SOUTH FEDERAL HIGHWAY,  
POMPANO BEACH, FL 33062**

Title		<b>PLANTING PLAN GROUNDWORK</b>	
Drawn	<b>GS LA</b>	Field	<b>LANDSCAPE ARCH</b>
Verified	<b>KG</b>	Scale	<b>as shown</b>
Approved	<b>KG</b>	Date	<b>10-09-2024</b>
Project Manager <b>KG</b>		Dwg. no.	
Project <b>24-838</b>		<b>L-204</b>	

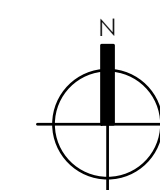

## PLANTING PLAN - GROUND FLOOR

